

HOW TO MEASURE YOUR OPENING

PG 1

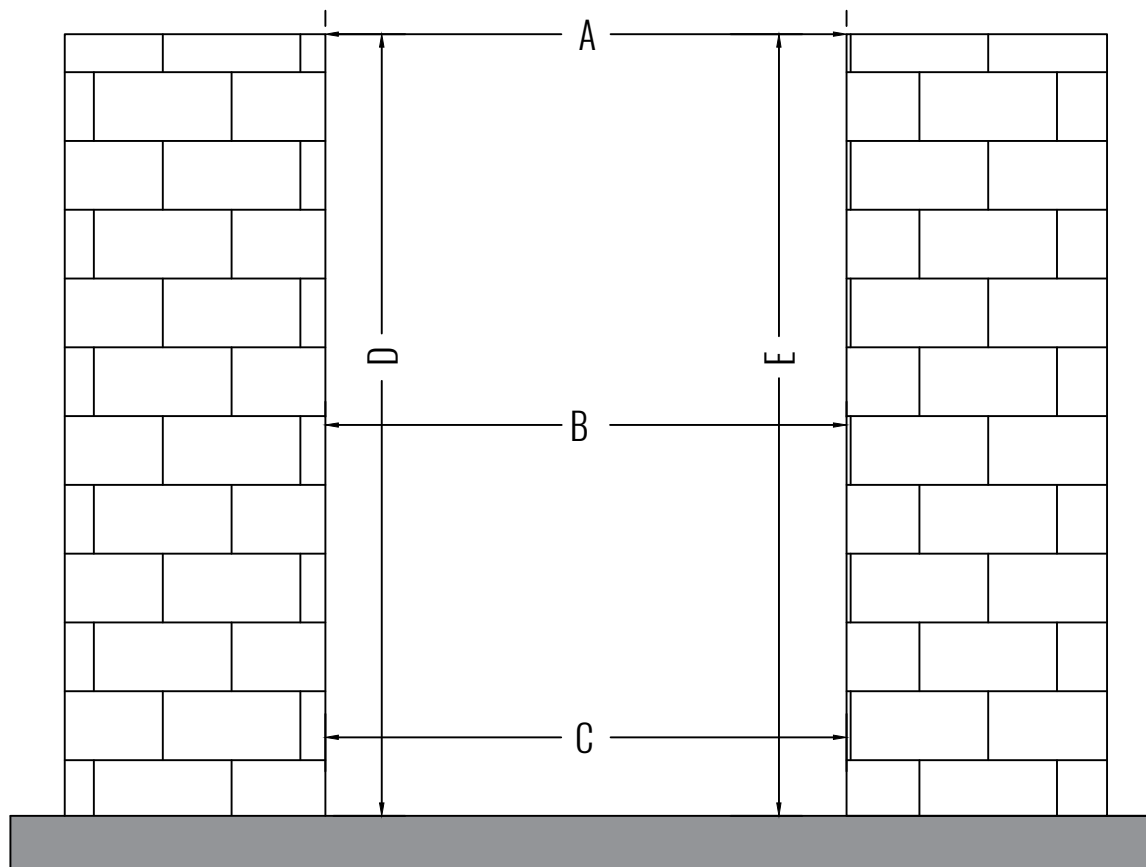

MEASUREMENTS FROM OUTSIDE LOOKING IN



POST INSTALLATION

PG 2

RECOMMENDED
ANCHOR
3/8"X3
- SLEEVE ON BRICK
AND BLOCK
- WEDGE ON
CONCRETE

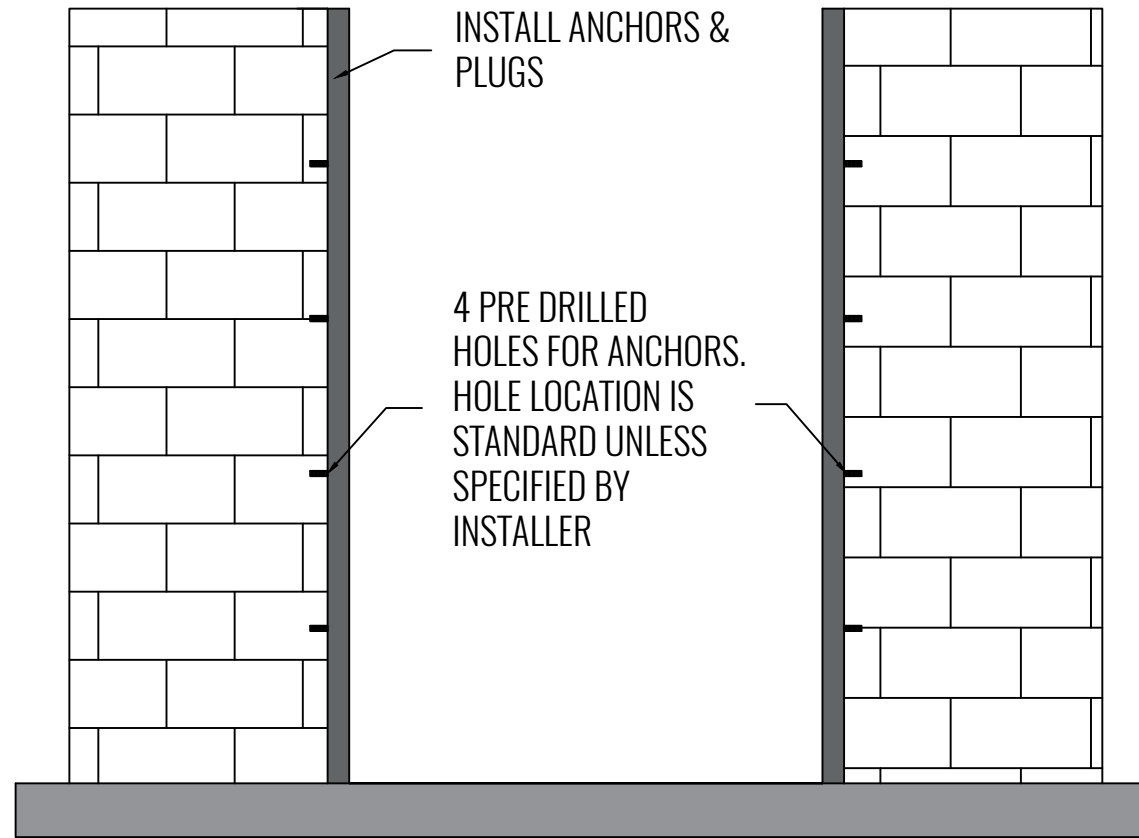

HINGES COME PRE-MOUNTED

STANDARD HINGE TYPE:
4"X4" HEAVY DUTY BALL
BEARING BUTT HINGES

OTHER STYLES
AVAILABLE
(SELF CLOSING
HINGES)

GATE & JAMBS
ARE MORTISED
FOR THE HINGE

SCREW HOLES ARE
MACHINE THREADED INTO
THE GATE & JAMB.
SCREWS ARE 12/24X1"
STAINLESS STEEL
(SCREWS INCLUDED)

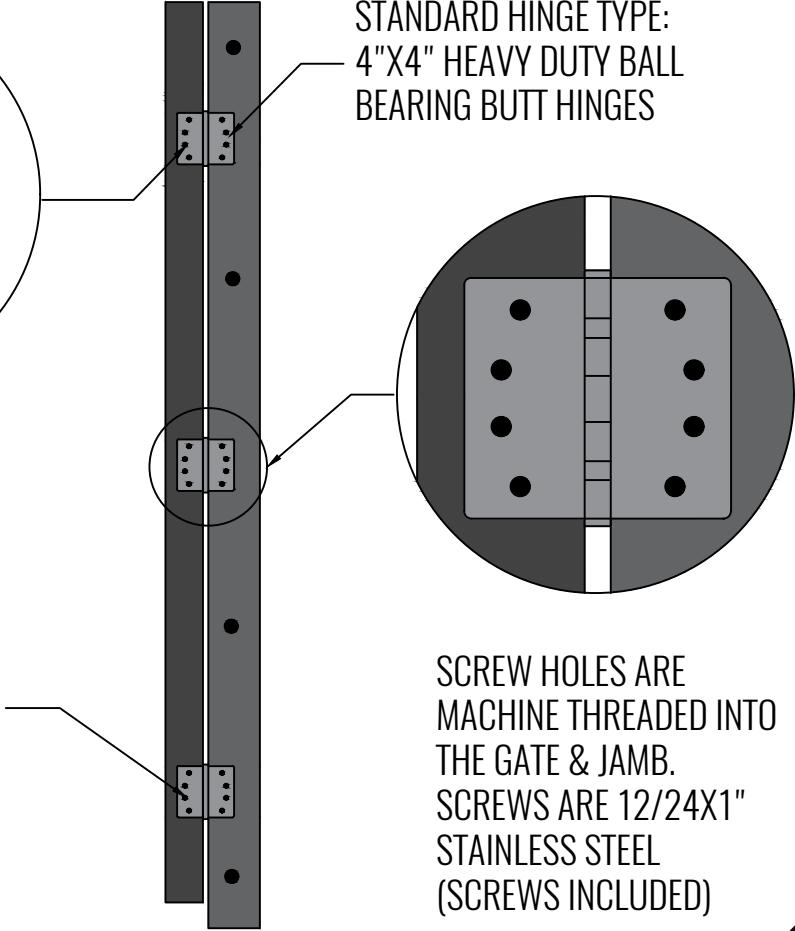

STANDARD DIMENSIONS

PG 4

